



NOTICE OF MEETING

Special Licensing Sub-Committee B

WEDNESDAY, 2ND APRIL, 2008 at 19:30 HRS - CIVIC CENTRE, HIGH ROAD, WOOD GREEN, N22 8LE.

MEMBERS: Councillors Lister, Peacock (Chair) and Reid

AGENDA

1. APOLOGIES FOR ABSENCE

2. URGENT BUSINESS

The Chair will consider the admission of any late items of urgent business under the agenda item where they appear.

3. DECLARATIONS OF INTEREST

A member with a personal interest in a matter who attends a meeting of the authority at which the matter is considered must disclose to that meeting the existence and nature of that interest at the commencement of that consideration, or when the interest becomes apparent.

A member with a personal interest in a matter also has a prejudicial interest in that matter if the interest is one which a member of the public with knowledge of the relevant facts would reasonably regard as so significant that it is likely to prejudice the member's judgement of the public interest **and** if this interest affects their financial position or the financial position of a person or body as described in paragraph 8 of the Code of Conduct **and/or** if it relates to the determining of any approval, consent, licence, permission or registration in relation to them or any person or body described in paragraph 8 of the Code of Conduct.

4. SUMMARY OF PROCEDURE (PAGES 1 - 2)

The Chair will explain the procedure that the Committee will follow for the hearing considered under the Licensing Act 2003. A copy of the procedure is attached.

5. MEZZO, 64 GRAND PARADE N4 (HARRINGAY WARD) (PAGES 3 - 54)

To consider an application to allow the Sale of Alcohol, Provision of Late Night Refreshment and Provision of Regulated Entertainment at the above premises.

6. GRILL KEBAB HOUSE, 270 MUSWELL HILL N10 (MUSWELL HILL WARD) (PAGES 55 - 90)

To consider an application to allow Late Night Refreshment at the above premises.

Please note that under the Council's Constitution – Part 4, Section B, Paragraph 17 no other business shall be transacted at the meeting.

Yuniea Semambo
Head of Member Services
5th Floor
River Park House
225 High Road
Wood Green
London N22 8HQ

Anne Thomas
Principal Support Officer (Council)
Tel: 020-8489 2941
Fax: 020-8489 2660
Email: anne.thomas@haringey.gov.uk

Thursday, 20 March 2008

LICENSING SUB-COMMITTEE HEARINGS PROCEDURE SUMMARY	
INTRODUCTION	
1.	The Chair introduces himself and invites other Members, Council officers, Police, Applicant and Objectors to do the same.
2.	The Chair invites Members to disclose any prior contacts (before the hearing) with the parties or representations received by them
3.	The Chair explains the procedure to be followed by reference to this summary which will be distributed.
NON-ATTENDANCE BY PARTY OR PARTIES	
4.	If one or both of the parties fails to attend, the Chair decides whether to:
	(i) grant an adjournment to another date, or
	(ii) proceed in the absence of the non-attending party.
	Normally, an absent party will be given one further chance to attend.
TOPIC HEADINGS	
5.	The Chair suggests the “topic headings” for the hearing. In the case of the majority of applications for variation of hours, or other terms and conditions, the main topic is:
	Whether the extensions of hours etc. applied for would conflict with the four licensing objectives i.e.
	(i) the prevention of crime and disorder,
	(ii) public safety,
	(iii) the prevention of public nuisance, and
	(iv) the protection of children from harm.
6.	The Chair invites comments from the parties on the suggested topic headings and decides whether to confirm or vary them.
WITNESSES	
7.	The Chair asks whether there are any requests by a party to call a witness and decides any such request.
8.	Only if a witness is to be called, the Chair then asks if there is a request by an opposing party to “cross-examine” the witness. The Chair then decides any such request.
DOCUMENTARY EVIDENCE	
9.	The Chair asks whether there are any requests by any party to introduce late documentary evidence.
10.	If so, the Chair will ask the other party if they object to the admission of the late documents.
11.	If the other party do object to the admission of documents which have only been produced by the first party at the hearing, then the documents shall not be admitted.

12.	If the other party object to documents produced late but before the hearing, the following criteria shall be taken into account when the Chair decides whether or not to admit the late documents:	
(i)	What is the reason for the documents being late?	
(ii)	Will the other party be unfairly taken by surprise by the late documents?	
(iii)	Will the party seeking to admit late documents be put at a major disadvantage if admission of the documents is refused?	
(iv)	Is the late evidence really important?	
(v)	Would it be better and fairer to adjourn to a later date?	
THE LICENSING OFFICER'S INTRODUCTION		
13.	The Licensing Officer introduces the report explaining, for example, the existing hours, the hours applied for and the comments of the other Council Services or outside official bodies. This should be as "neutral" as possible between the parties.	
14.	The Licensing Officer can be questioned by Members and then by the parties.	
THE HEARING		
15.	This takes the form of a discussion led by the Chair. The Chair can vary the order as appropriate but it should include:	
(i)	an introduction by the Objectors' main representative	
(ii)	an introduction by the Applicant or representative	
(iii)	questions put by Members to the Objectors	
(iv)	questions put by Members to the Applicant	
(v)	questions put by the Objectors to the Applicant	
(vi)	questions put by the Applicant to the Objectors	
CLOSING ADRESSES		
16.	The Chair asks each party how much time is needed for their closing address, if they need to make one.	
17.	Generally, the Objectors make their closing address before the Applicant who has the right to the final closing address.	
THE DECISION		
18.	Members retire with the Committee Clerk and legal representative to consider their decision including the imposition of conditions.	
19.	The decision is put in writing and read out in public by the Committee Clerk once Members have returned to the meeting.	

Licensing Act 2003 Sub-Committee on 2nd April 2008

Report title: Application for a new Premises Licence at MEZZO, 64 GRAND PARADE, GREEN LANES, LONDON N4 1AF

Report of: The Lead Officer Licensing

Ward(s) affected Harringay

1. Purpose

To consider an application by MR SULEYMAN AKSOY to allow Sale of Alcohol, Provision of Late Night Refreshment and Provision of Regulated Entertainment at the above premises.

2. Recommendations

- 2.1 (a) Grant the application as asked
 (b) Modify the conditions of the licence, by altering or omitting or adding to them
 (c) Reject the whole or part of the application

The Committee is asked to note that it may not modify the conditions or reject the whole or part of the application unless it is necessary to promote the licensing objectives.

Report authorised by: Robin Payne.....



Assistant Director Enforcement Services

Contact Officer: Ms Daliah Barrett -Williams

Telephone: 020 8489 8232

3. Executive summary

For consideration by Sub Committee under Licensing Act 2003 for a Premises licence with variation to the existing conditions

4. Access to information:

Local Government (Access to Information) Act 1985

Background Papers

The following Background Papers are used in the preparation of this Report:

File: MEZZO

The Background Papers are located at Enforcement Service, Technopark, Ashley Road, Tottenham, London N17 9LN

This page is intentionally left blank

5. REPORT**Background**

5.1 An application for a new Premises Licence, by Mr Suleyman Aksoy in respect of Mezzo, 64 Grand Parade, Green Lanes, London N4 1AF under the Licensing Act 2003.

5.2 **Details of new application being sought under a new Premises Licence APP1**

Provision of Regulated Entertainment (live music, recorded music, performances of dance)

Monday to Sunday 10:00 to 01:30

Provision of Entertainment Facilities (making music, dancing)

Monday to Sunday 10:00 to 01:30

Provision of Late Night Refreshment

Monday to Sunday 23:00 to 02:00

Supply of Alcohol

Monday to Sunday 10:00 to 01:30

Opening Times

Monday to Sunday 07:00 to 02:00

General-all four licensing objectives

The standard practices listed below will be maintained at all times. All reasonable steps will be taken to ensure that the premises will have a positive impact upon the local environment and its residents at all times.

5.3 **Crime and Disorder**

CCTV system shall be installed and maintained inside and outside the premises, including a CCTV unit, which monitors the immediate vicinity of the premises.

All cameras shall continue record whilst the premises are open to the public and the recordings shall be kept available for a minimum of 31 days with time and date stamping.

Recordings shall be made available to an authorised officer or a police officer within 24 hours of any request.

5.4 **Public Safety**

Appropriate fire safety procedures are in place along with appliances including fire extinguishers (Foam, H2O and CO2), fire blankets, internally

illuminated fire exit signs, a smoke detector and emergency lighting.
All appliances are checked annually and comply with relevant British Standards.

All fire escapes/escape routes will be clearly marked and kept free from obstructions at all times.

5.5 Public Nuisance

All customers are asked to respect the surroundings and behave in an orderly manner.

Signs will be installed to remind customers to respect the neighbours and leave quietly.

Patrons will be discouraged from congregating outside the premises.

All waste generated by the premises will be dealt with accordingly.

5.6 Child Protection

Restrictions under the Licensing Act 2003 will apply.

Alcohol will only be served to those over the age of 18.

The licensee and staff will ask persons who appear to be under the age of 18 for photographic ID such as proof of age cards, the Connexions Card and Citizen Card, photographic driving licence or passport, an official identity card issued by HM Forces or by an EU country, bearing the photograph and date of birth of bearer.

6. RELEVANT REPRESENTATIONS (CONSULTATION)

Responsible authorities:

6.1 Comments of Metropolitan Police

Have made no representation on this application.

6.2 Comments of Enforcement Services:

Noise Team

Have made no comments.

Food Team

Have made no observations.

Health and Safety

Have no objections to this application

Trading Standards

Have no objections to this application

6.3 Fire Officer

Have made no objection to this application

6.4 Planning Officer

Have made no comments on this application.

6.5 Comments of Child Protection Agency or Nominee

No representation made

7.0 Interested Parties –APP2

5 letters of representation have been received against this application.

8.0 Financial Comments

The fee which would be applicable for this application was **£190.00**

Licensing Officer Comments

The premises has benefited from a premises license previously which allowed the for late night refreshment only – App 3



Reproduced from the Ordnance Survey mapping with the permission of the Controller of Her Majesty's Stationery Office. © Crown copyright. Unauthorised reproduction infringes crown copyright and may lead to prosecution or civil proceedings. LB Haringey LA086401 2004

Site plan

Mezzo, 64 Grand Parade, Green Lanes N4

HARINGEY COUNCIL

**Directorate of
Environmental
Services**

Robin Payne
Assistant Director
Enforcement Service
639 High Road
London N17 8BD
Tel 020 8489 0000
Fax 020 8489 5525

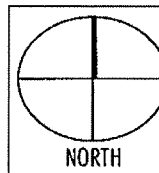

Drawn by	DW
Scale	1:1000
Date	19/03/2008

APP 1

APPLICATION FORM

**Application for a premises licence to be granted
under the Licensing Act 2003**

PLEASE READ THE FOLLOWING INSTRUCTIONS FIRST

Before completing this form please read the guidance notes at the end of the form.
If you are completing this form by hand please write legibly in block capitals. In all cases ensure that your answers are inside the boxes and written in black ink. Use additional sheets if necessary.
You may wish to keep a copy of the completed form for your records.

I/We **MR SULEYMAN AKSOY**

(Insert name(s) of applicant)

apply for a premises licence under section 17 of the Licensing Act 2003 for the premises described in Part 1 below (the premises) and I/we are making this application to you as the relevant licensing authority in accordance with section 12 of the Licensing Act 2003

Part 1 – Premises Details

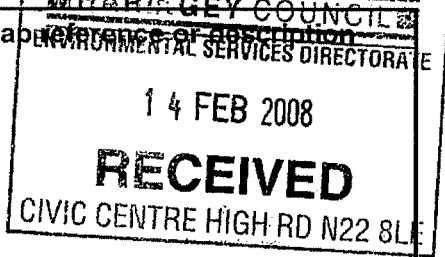
Postal address of premises or, if none, Ordnance Survey map reference or description MEZZO 64 GRAND PARADE GREEN LANES				
Post town	LONDON	Post code	N4 1AF	

Telephone number at premises (if any)	
Non-domestic rateable value of premises	£13500

Part 2 - Applicant Details

Please state whether you are applying for a premises licence as
Please tick yes

- a) an individual or individuals * please complete section (A)
- b) a person other than an individual *
 - i. as a limited company please complete section (B)
 - ii. as a partnership please complete section (B)
 - iii. as an unincorporated association or please complete section (B)
 - iv. other (for example a statutory corporation) please complete section (B)
- c) a recognised club please complete section (B)
- d) a charity please complete section (B)

- e) the proprietor of an educational establishment please complete section (B)
- f) a health service body please complete section (B)
- g) a person who is registered under Part 2 of the Care Standards Act 2000 (c14) in respect of an independent hospital please complete section (B)
- h) the chief officer of police of a police force in England and Wales please complete section (B)

* If you are applying as a person described in (a) or (b) please confirm:

Please tick yes

- I am carrying on or proposing to carry on a business which involves the use of the premises for licensable activities; or
- I am making the application pursuant to a
 - statutory function or
 - a function discharged by virtue of Her Majesty's prerogative

(A) INDIVIDUAL APPLICANTS (fill in as applicable)

Mr <input checked="" type="checkbox"/>	Mrs <input type="checkbox"/>	Miss <input type="checkbox"/>	Ms <input type="checkbox"/>	Other Title (for example, Rev)	
Surname AKSOY			First names SULEYMAN		
I am 18 years old or over				<input checked="" type="checkbox"/> Please tick yes	
Current postal address if different from premises address		FLAT 5, 155A FORE STREET EDMONTON			
Post Town	LONDON			Postcode	N18 2XB
Daytime contact telephone number					
E-mail address (optional)					

SECOND INDIVIDUAL APPLICANT (if applicable)

Mr <input type="checkbox"/>	Mrs <input type="checkbox"/>	Miss <input type="checkbox"/>	Ms <input type="checkbox"/>	Other Title (for example, Rev)	
Surname			First names		
I am 18 years old or over				<input type="checkbox"/> Please tick yes	

Current postal address if different from premises address			
Post Town		Postcode	
Daytime contact telephone number			
E-mail address (optional)			

(B) OTHER APPLICANTS

Please provide name and registered address of applicant in full. Where appropriate please give any registered number. In the case of a partnership or other joint venture (other than a body corporate), please give the name and address of each party concerned.

Name
Address
Registered number (where applicable)
Description of applicant (for example, partnership, company, unincorporated association etc.)
Telephone number (if any)
E-mail address (optional)

Part 3 Operating Schedule

When do you want the premises licence to start?

Day	Month	Year
0	5	032008

If you wish the licence to be valid only for a limited period, when do you want it to end?

Day	Month	Year

Please give a general description of the premises (please read guidance note1)
CAFÉ SHOP. please refer to plans

If 5,000 or more people are expected to attend the premises at any one time, please state the number expected to attend.

What licensable activities do you intend to carry on from the premises?

(Please see sections 1 and 14 of the Licensing Act 2003 and Schedules 1 and 2 to the Licensing Act 2003)

Provision of regulated entertainment

Please tick yes

- a) plays (if ticking yes, fill in box A)
- b) films (if ticking yes, fill in box B)
- c) indoor sporting events (if ticking yes, fill in box C)
- d) boxing or wrestling entertainment (if ticking yes, fill in box D)
- e) live music (if ticking yes, fill in box E)
- f) recorded music (if ticking yes, fill in box F)
- g) performances of dance (if ticking yes, fill in box G)
- h) anything of a similar description to that falling within (e), (f) or (g) (if ticking yes, fill in box H)

Provision of entertainment facilities:

- i) making music (if ticking yes, fill in box I)
- j) dancing (if ticking yes, fill in box J)
- k) entertainment of a similar description to that falling within (i) or (j) (if ticking yes, fill in box K)

Provision of late night refreshment (if ticking yes, fill in box L)

Supply of alcohol (if ticking yes, fill in box M)

In all cases complete boxes N, O and P

A

Plays Standard days and timings (please read guidance note 6)			Will the performance of a play take place <u>indoors or outdoors or both</u> – please tick (please read guidance note 2)	Indoors	<input type="checkbox"/>
				Outdoors	<input type="checkbox"/>
Day	Start	Finish		Both	<input type="checkbox"/>
Mon				Please give further details here (please read guidance note 3)	
Tue			State any seasonal variations for performing plays (please read guidance note 4)		
Wed			Non standard timings. Where you intend to use the premises for the performance of plays at different times to those listed in the column on the left, please list (please read guidance note 5)		
Thur					
Fri					
Sat					
Sun					

B

Films Standard days and timings (please read guidance note 6)			Will the exhibition of films take place indoors or outdoors or both – please tick (please read guidance note 2)	Indoors	<input type="checkbox"/>
				Outdoors	<input type="checkbox"/>
				Both	<input type="checkbox"/>
Day	Start	Finish	Please give further details here (please read guidance note 3)		
Mon					
Tue			State any seasonal variations for the exhibition of films (please read guidance note 4)		
Wed					
Thur			Non standard timings. Where you intend to use the premises for the exhibition of films at different times to those listed in the column on the left, please list (please read guidance note 5)		
Fri					
Sat					
Sun					

C

Indoor sporting events Standard days and timings (please read guidance note 6)			Please give further details (please read guidance note 3)
Day	Start	Finish	
Mon			State any seasonal variations for indoor sporting events (please read guidance note 4)
Tue			
Wed			Non standard timings. Where you intend to use the premises for indoor sporting events at different times to those listed in the column on the left, please list (please read guidance note 5)
Thur			
Fri			
Sat			
Sun			

D

Boxing or wrestling entertainments Standard days and timings (please read guidance note 6)			Will the boxing or wrestling entertainment take place indoors or outdoors or both – please tick (please read guidance note 2)	Indoors	<input type="checkbox"/>
				Outdoors	<input type="checkbox"/>
				Both	<input type="checkbox"/>
Day	Start	Finish			
Mon			Please give further details here (please read guidance note 3)		
Tue					
Wed			State any seasonal variations for boxing or wrestling entertainment (please read guidance note 4)		
Thur					
Fri			Non standard timings. Where you intend to use the premises for boxing or wrestling entertainment at different times to those listed in the column on the left, please list (please read guidance note 5)		
Sat					
Sun					

E

Live music Standard days and timings (please read guidance note 6)			Will the performance of live music take place <u>indoors or outdoors or both – please tick</u> (please read guidance note 2)	Indoors	<input checked="" type="checkbox"/>		
Day				Start	Finish	Outdoors	<input type="checkbox"/>
						Both	<input type="checkbox"/>
Mon	10:00	01:30		<u>Please give further details here</u> (please read guidance note 3)			
Tue	10:00	01:30					
Wed	10:00	01:30	<u>State any seasonal variations for the performance of live music</u> (please read guidance note 4)				
Thur	10:00	01:30					
Fri	10:00	01:30	<u>Non standard timings. Where you intend to use the premises for the performance of live music at different times to those listed in the column on the left, please list</u> (please read guidance note 5)				
Sat	10:00	01:30					
Sun	10:00	01:30					

F

Recorded music Standard days and timings (please read guidance note 6)			Will the playing of recorded music take place indoors or outdoors or both – please tick (please read guidance note 2)	Indoors	<input checked="" type="checkbox"/>
Day	Start	Finish		Outdoors	<input type="checkbox"/>
Mon	10:00	01:30	Please give further details here (please read guidance note 3)	Both	<input type="checkbox"/>
Tue	10:00	01:30			
Wed	10:00	01:30	State any seasonal variations for the playing of recorded music (please read guidance note 4)		
Thur	10:00	01:30			
Fri	10:00	01:30	Non standard timings. Where you intend to use the premises for the playing of recorded music at different times to those listed in the column on the left, please list (please read guidance note 5)		
Sat	10:00	01:30			
Sun	10:00	01:30			

G

Performances of dance Standard days and timings (please read guidance note 6)			Will the performance of dance take place indoors or outdoors or both – please tick (please read guidance note 2)	Indoors	<input checked="" type="checkbox"/>
Day	Start	Finish		Outdoors	<input type="checkbox"/>
Mon	10:00	01:30	Please give further details here (please read guidance note 3)	Both	<input type="checkbox"/>
Tue	10:00	01:30			
Wed	10:00	01:30	State any seasonal variations for the performance of dance (please read guidance note 4)		
Thur	10:00	01:30			
Fri	10:00	01:30	Non standard timings. Where you intend to use the premises for the performance of dance at different times to those listed in the column on the left, please list (please read guidance note 5)		
Sat	10:00	01:30			
Sun	10:00	01:30			

H

<p>Anything of a similar description to that falling within (e), (f) or (g) Standard days and timings (please read guidance note 6)</p>			<p><u>Please give a description of the type of entertainment you will be providing</u></p>		
Day	Start	Finish	<p><u>Will this entertainment take place indoors or outdoors or both – please tick</u> (please read guidance note 2)</p>	Indoors	<input type="checkbox"/>
Mon				Outdoors	<input type="checkbox"/>
				Both	<input type="checkbox"/>
Tue			<p><u>Please give further details here</u> (please read guidance note 3)</p>		
Wed					
Thur			<p><u>State any seasonal variations for entertainment of a similar description to that falling within (e), (f) or (g)</u> (please read guidance note 4)</p>		
Fri					
Sat			<p><u>Non standard timings. Where you intend to use the premises for the entertainment of a similar description to that falling within (e), (f) or (g) at different times to those listed in the column on the left, please list</u> (please read guidance note 5)</p>		
Sun					

I

Provision of facilities for making music Standard days and timings (please read guidance note 6)			<u>Please give a description of the facilities for making music you will be providing</u>		
			<u>Will the facilities for making music be indoors or outdoors or both – please tick</u> (please read guidance note 2)		Indoors
			Outdoors	<input type="checkbox"/>	
			Both	<input type="checkbox"/>	
Day	Start	Finish	<u>Please give further details here</u> (please read guidance note 3)		
Mon	10:00	01:30			
Tue	10:00	01:30			
			<u>State any seasonal variations for the provision of facilities for making music</u> (please read guidance note 4)		
Wed	10:00	01:30			
Thur	10:00	01:30			
			<u>Non standard timings. Where you intend to use the premises for provision of facilities for making music at different times to those listed in the column on the left, please list</u> (please read guidance note 5)		
Fri	10:00	01:30			
Sat	10:00	01:30			
Sun	10:00	01:30			

J

Provision of facilities for dancing Standard days and timings (please read guidance note 6)			Will the facilities for dancing be indoors or outdoors or both – please tick (see guidance note 2)	Indoors	<input checked="" type="checkbox"/>
				Outdoors	<input type="checkbox"/>
				Both	<input type="checkbox"/>
			<u>Please give a description of the facilities for dancing you will be providing</u>		
Day	Start	Finish			
Mon	10:00	01:30	<u>Please give further details here</u> (please read guidance note 3)		
Tue	10:00	01:30			
Wed	10:00	01:30	<u>State any seasonal variations for providing dancing facilities</u> (please read guidance note 4)		
Thur	10:00	01:30			
Fri	10:00	01:30	<u>Non standard timings. Where you intend to use the premises for the provision of facilities for dancing entertainment at different times to those listed in the column on the left, please list</u> (please read guidance note 5)		
Sat	10:00	01:30			
Sun	10:00	01:30			

K

Provision of facilities for entertainment of a similar description to that falling within i or j Standard days and timings (please read guidance note 6)			<u>Please give a description of the type of entertainment facility you will be providing</u>		
Day	Start	Finish	<u>Will the entertainment facility be indoors or outdoors or both – please tick</u> (please read guidance note 2)	Indoors	<input type="checkbox"/>
Mon				Outdoors	<input type="checkbox"/>
				Both	<input type="checkbox"/>
Tue			<u>Please give further details here</u> (please read guidance note 3)		
Wed					
Thur			<u>State any seasonal variations for the provision of facilities for entertainment of a similar description to that falling within i or j</u> (please read guidance note 4)		
Fri					
Sat			<u>Non standard timings. Where you intend to use the premises for the provision of facilities for entertainment of a similar description to that falling within i or j at different times to those listed in the column on the left, please list</u> (please read guidance note 5)		
Sun					

L

Late night refreshment Standard days and timings (please read guidance note 6)			Will the provision of late night refreshment take place indoors or outdoors or both – please tick (please read guidance note 2)	Indoors	<input type="checkbox"/>
				Outdoors	<input type="checkbox"/>
				Both	<input checked="" type="checkbox"/>
Day	Start	Finish			
Mon	23:00	02:00	<u>Please give further details here</u> (please read guidance note 3)		
Tue	23:00	02:00			
Wed	23:00	02:00	<u>State any seasonal variations for the provision of late night refreshment</u> (please read guidance note 4)		
Thur	23:00	02:00			
Fri	23:00	02:00	<u>Non standard timings. Where you intend to use the premises for the provision of late night refreshment at different times, to those listed in the column on the left, please list</u> (please read guidance note 5)		
Sat	23:00	02:00			
Sun	23:00	02:00			

M

Supply of alcohol Standard days and timings (please read guidance note 6)			Will the supply of alcohol be for consumption (Please tick box) (please read guidance note 7)	On the premises	<input checked="" type="checkbox"/>
				Off the premises	<input type="checkbox"/>
				Both	<input type="checkbox"/>
Day	Start	Finish			
Mon	10:00	01:30	State any seasonal variations for the supply of alcohol (please read guidance note 4)		
Tue	10:00	01:30			
Wed	10:00	01:30			
Thur	10:00	01:30	Non standard timings. Where you intend to use the premises for the supply of alcohol at different times to those listed in the column on the left, please list (please read guidance note 5)		
Fri	10:00	01:30			
Sat	10:00	01:30			
Sun	10:00	01:30			

State the name and details of the individual whom you wish to specify on the licence as premises supervisor

Name MR SULEYMAN AKSOY	
Address FLAT 5, 155A FORE STREET EDMONTON LONDON	
Postcode	N18 2XB
Personal Licence number (if known) APPLICATION IN PROGRESS	
Issuing licensing authority (if known) L.B. OF ENFIELD	

N

Please highlight any adult entertainment or services, activities, other entertainment or matters ancillary to the use of the premises that may give rise to concern in respect of children (please read guidance note 8)

N/A

O

Hours premises are open to the public Standard days and timings (please read guidance note 6)			State any seasonal variations (please read guidance note 4)
Day	Start	Finish	
Mon	07:00	02:00	
Tue	07:00	02:00	
Wed	07:00	02:00	
Thur	07:00	02:00	
Fri	07:00	02:00	
Sat	07:00	02:00	
Sun	07:00	02:00	
			Non standard timings. Where you intend the premises to be open to the public at different times from those listed in the column on the left, please list (please read guidance note 5)

P Describe the steps you intend to take to promote the four licensing objectives:

a) General – all four licensing objectives (b,c,d,e) (please read guidance note 9)

The standard practices listed below will be maintained at all times. All reasonable steps will be taken to ensure that the premises will have a positive impact upon the local environment and its residents at all times.

b) The prevention of crime and disorder

CCTV system shall be installed and maintained inside and outside the premises, including a CCTV unit, which monitors the immediate vicinity of the premises. All cameras shall continually record whilst the premises are open to the public and the recordings shall be kept available for a minimum of 31 days with time and date stamping. Recordings shall be made available to an authorised officer or a police officer with 24 hours of any request

c) Public safety

Appropriate fire safety procedures are in place along with appliances including fire extinguishers (Foam, H2O and CO2), fire blankets, internally illuminated fire exit signs, a smoke detector and emergency lighting. All appliances are checked annually and comply with relevant British Standards.

All fire escapes/escape routes will be clearly marked and kept free from obstructions at all times.

d) The prevention of public nuisance

All customers are asked to respect the surroundings and behave in an orderly manner.

Signs will be installed to remind customers respect neighbours and leave quietly.

Patrons will be discouraged from congregating outside the premises.

All waste generated by the premises will be dealt with appropriately.

e) The protection of children from harm

Restrictions under the Licensing Act 2003 will apply.

Alcohol will only be served over 18's only.

The licensee and staff will ask persons who appear to be under the age of 18 for photographic ID such as proof of age cards, the Connexions Card and Citizen Card, photographic driving licence or passport, an official identity card issued by HM Forces or by an EU country, bearing the photograph and date of birth of bearer.

Please tick yes

- I have made or enclosed payment of the fee
- I have enclosed the plan of the premises
- I have sent copies of this application and the plan to responsible authorities and others where applicable
- I have enclosed the consent form completed by the individual I wish to be premises supervisor, if applicable
- I understand that I must now advertise my application
- I understand that if I do not comply with the above requirements my application will be rejected

IT IS AN OFFENCE, LIABLE ON CONVICTION TO A FINE UP TO LEVEL 5 ON THE STANDARD SCALE, UNDER SECTION 158 OF THE LICENSING ACT 2003 TO MAKE A FALSE STATEMENT IN OR IN CONNECTION WITH THIS APPLICATION

Part 4 – Signatures (please read guidance note 10)

Signature of applicant or applicant's solicitor or other duly authorised agent (See guidance note 11). **If signing on behalf of the applicant please state in what capacity.**

Signature	
Date	04.02.2008
Capacity	APPLICANT'S AGENT

For joint applications signature of 2nd applicant or 2nd applicant's solicitor or other authorised agent. (please read guidance note 12). **If signing on behalf of the applicant please state in what capacity.**

Signature	
Date	
Capacity	

Contact name (where not previously given) and postal address for correspondence associated with this application (please read guidance note 13)			
STEVANS ALLAN & CO 90 GREEN LANES			
Post town	LONDON	Post code	N16 9EJ
Telephone number (if any)			
If you would prefer us to correspond with you by e-mail your e-mail address (optional) WE ACCEPT CORRESPONSE BY LETTER ONLY			

and any premises licence to be granted or varied in respect of this application made by

MR SULEYMAN AKSOY
[name of applicant]

concerning the supply of alcohol at

MEZZO
64 Grand Parade
Green Lanes, Haringey
London N4 1AF
[name and address of premises to which application relates]

I also confirm that I am applying for, intend to apply for or currently hold a personal licence, details of which I set out below.

Personal licence number

NOT KNOWN / Application in progress.
[insert personal licence number, if any]

Personal licence issuing authority

L. B of Enfield.
[insert name and address and telephone number of personal licence issuing authority, if any]

Signed



Name (please print)

MR SULEYMAN AKSOY

Date

11th JAN 08

Not applied yet
11am 07/02/08
Enfield
Council

Consent of individual to being specified as premises supervisor

MR SULEYMAN AKSOY
[full name of prospective premises supervisor]

of FLATS 155A FORE STREET
EDMONTON N18 2XB

[home address of prospective premises supervisor]

hereby confirm that I give my consent to be specified as the designated premises supervisor in relation to the application for

TRANSFER OF LICENCE
[type of application]

by

MR SULEYMAN AKSOY
[name of applicant]

relating to a premises licence LN0000 2130
[number of existing licence, if any]

for

ME220
64 Grand Parade, Green Lanes
Haringey, London N4 1AF

[name and address of premises to which the application relates]

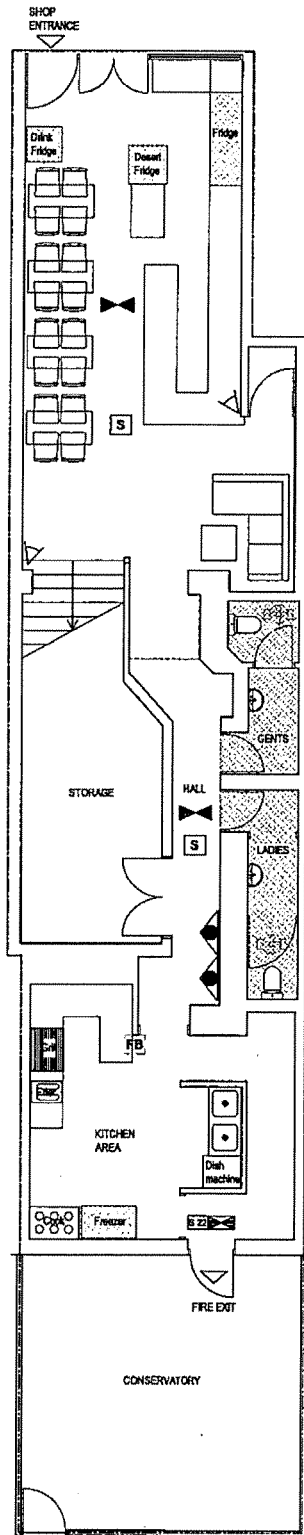

GROUND FLOOR PLAN

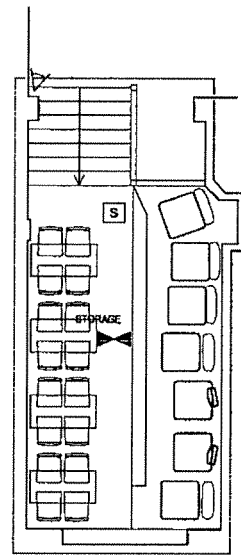

FIRST FLOOR PLAN

not to scale

LEGEND

- WC AREA
- FRIDGES
- AMBIT OF LICENSED PREMISES
- SAFETY LIGHTS
- SMOKE DETECTOR
- CCTV
- FIRE ESCAPE KEEP CLEAR
- INTERNALLY ILLUMINATED FIRE ESCAPE SIGN (BS 5266)
- 9 LT. FOAM FIRE EXTINGUISHER
- FIRE BLANKET
- FAN

MEZZO BAR & RESTAURANT

64 GRAND PARADE
GREEN LANES
LONDON
N4 1AF

PROPOSED PLANS

SCALE : 1/100@A3

DATE :16/01/08

REF. NO : O160108

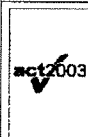

ACT 2003
90 Green Lanes LONDON
N16 9EJ

Tel : 020 7241 3638(4line)

www.act2003.com

APP 2

LETTERS FROM INTERESTED PARTIES

LADDER COMMUNITY SAFETY PARTNERSHIP ...keeping crime off

P.O. Box 32109 Haringey London N4 1GN
lcsp@blueyonder.co.uk

Recd
10/3/08
D/A

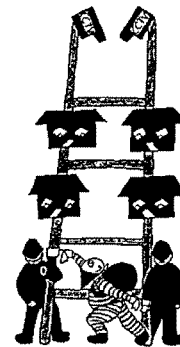

the "Ladder"

Ms D Barrett
Lead Licensing Officer
Haringey Council
Techno Park
Ashley Rd
London N17 9LN

6 March 2008

Dear Ms Barrett

**Late-night premises licence application: Mezzo, 64 Grand Parade, N4 1AF
Applying for Mon-Sunday 07.00 -02.00 late-night café
and provision of live and recorded music, dancing etc.**

1 INTRODUCTION

The Ladder Community Safety Partnership (LCSP) contains representatives of Neighbourhood Watches and Residents' Associations both from the 'Ladder' roads, and in Green Lanes itself. We are an independent group, although working in partnership with Haringey Council and the Metropolitan Police where appropriate.

We are writing to you as members of the LCSP to oppose this application.

We believe that in the context of the well known problems in the area, granting a licence for the activities and hours requested would be against the general principles of Haringey's Licencing Policy and specifically under the following headings:

- The Prevention of Crime and Disorder
- Public Safety
- Prevention of Public Nuisance

We are concerned, in particular, at the issues surrounding the prevention of public nuisance, in the light of the applicant's request for live music and dancing until 1.30am daily and the late-night refreshment both indoors and outdoors until 2am daily.

More information on why we believe the Committee should reject this application is provided under appropriate headings below.

2 REASONS FOR OBJECTING

(a) Relevant sections of the Borough's Licensing Policy/Objectives

We believe the following statements in the Borough's Licensing Policy 2008 support our objections:

- *'the Council considers that licensing law plays a key role in both preventing and controlling ... anti-social behaviour ... by regulating and applying conditions to affect the number, location and hours of premises'* [2.7]
- *'this licensing policy statement is intended to support the Antisocial Behaviour Strategy by reducing the impact of drink related antisocial behaviour and the environmental crimes and nuisance that can be associated with licensed premises'* [7.12]
- *'the council will have special regard to the local impact of licensing on related crime and disorder ... particularly when concerning location, impact, operation and management of all proposed licenses, applications, renewals and variations of conditions'* [8.6]
- *'licensed premises, especially those operating late at night and in the early hours of the morning, can cause a wide range of nuisances that can impact on the people living, working or sleeping in the vicinity of the licensed premises. The Council is committed to protecting the residents in the vicinity of these licensed premises.'* [14.1]
- *'in particular, late night activities cause much of this nuisance. Late night cafes ... can have a number of adverse effects on the residents in the vicinity of these premises. Nuisance such as noise, litter, anti-social behaviour, lights and odour all contribute to the loss of amenity to the general public'* [14.2]
- *'noise nuisance is of particular concern'* [14.3]
- *'the potential for additional crime and disorder and/or public nuisance is increased with longer hours.'* [19.1]
- *'operating hours between 23.00 and 07.00 are considered to give greater potential for noise nuisance'* [19.3]

(b) Licensing Hours

In the light of the above statements and of the licensing objectives in general, we believe that a daily closing time of 2.00am is very late for ordinary weekday evenings, after which most residents will have to get up early to go to work. However, our major concerns are with the issues of live music daily until 1.30am and the outdoor late-night refreshment daily until 2am.

We believe that these are unreasonable propositions, given the location of the premises in the heart of one of the most densely populated residential areas in the borough.

(c) The Prevention of Crime and Disorder

We have seen the comments relating to the prevention of crime and disorder put forward by the applicant. Although helpful, they consist solely of comments on CCTV. We would like to highlight some of the provisions recommended by the Council on p30 of the Licensing Policy:

- are there policies/methods to deal with the arrival of intoxicated patrons and/or persons under the influence of illegal drugs?
- are patrons prevented from drinking alcohol brought onto the premises?
- are there procedures to deal with violence and anti-social behaviour?
- are there methods to discourage the drinking of alcohol in a public place in the vicinity of the premises?
- do staff have training in crime prevention measures?
- what risk assessment procedures are in place?

(d) Public Safety

We are pleased to see the measures proposed by the applicant regarding public safety. however, there is no reference to a Health and Safety statement or to capacity limits, whether to prevent overcrowding or to help prevent noise nuisance when leaving the premises. We assume that staff will be adequately supervised and trained in all emergency procedures, especially evacuation.

(e) Prevention of Public Nuisance

We welcome the statement that *'signs will be installed to remind customers to respect neighbours and leave quietly'*. However, some further questions remain unanswered, in particular:

- what measures are proposed to prevent noise and vibration escaping from the premises, including live music, noise from ventilation equipment and human voices? How can noise be prevented from customers who are taking late night refreshment outdoors until 2am?
- apart from signs, what steps will be taken, or proposed, to prevent disturbances by customers arriving at, or leaving, the premises? (the Policy states that *'there will be greater responsibilities placed on premises operating between 23.00 and 07.00 than at other times of the day'*)
- the actions necessary to prevent disturbance from deliveries or collections at early or late hours, or staff cleaning up after closing time?
- the provision to properly extract and disperse odours and smells from cooking by properly installed and maintained ventilation equipment? There seem to have been complaints in the past.
- the steps taken, or proposed, to prevent littering and fouling of public and open spaces - what specific measures are proposed by the business? This is particularly important if the premises also advertises a take-away service
- the arrangement for storage and disposal of trade waste - would the very long hours sought by the applicant lead to increased waste storage and disposal problems?
- the arrangements for cleansing and keeping clean the vicinity of the premises - this

will include litter, refuse and other items originating from the premises and fouling caused by customers.

The Borough's Licensing Policy points out the special importance of these issues after 23.00 and in residential areas. (See 14.1-14.3; 19.3 and Appendix 3 of the Licensing Policy).

3. CONCLUSION

We believe that the above points need to be clarified by the Licensing Committee and clearly specified in any licence granted.

Our comments and objections obviously make clear that residents are very concerned at the possible implications of a 19 hour daily licence for these premises, particularly because of the likely noise nuisance from live music and outdoor refreshment. Above all, have the owners taken sufficient measures to provide adequate sound insulation? We would therefore urge the Licensing Sub-committee to support a balanced decision bearing in mind both the concerns of local residents and the needs of the present applicant to continue to operate a successful business.

In the light of these concerns, we would urge the Licensing Sub-Committee to consider several different solutions, including either earlier closing times on Sunday-Thursday (when residents need a good night's sleep before work the next day) or granting the proposed hours but limiting music, dance and outdoor refreshment to no later than midnight (Sun-Thurs), on the understanding that neither is accompanied by any increase in noise nuisance etc. We believe that these proposals may be a workable way forward for residents and applicant alike

Yours sincerely

A handwritten signature in black ink, appearing to be 'J.S.P.', with a long horizontal flourish extending to the right.

on behalf of the LCSP

Barrett Daliah

From: François Ballay [francois@ballay1.demon.co.uk]
Sent: 11 March 2008 15:16
To: Barrett Daliah
Cc: Annette Elder; lcps@blueyonder.co.uk
Subject: Mezzo Café - 64 Grand parade Green Lanes - N4

Dear Ms Barrett

I am the owner of a house only three houses away from the above premises and it has been brought to my attention that Mezzo Café was putting an application for a change of license including live and recorded music, dancing, performances as well as providing food and drinks indoors and outdoors until 2am daily.

1 - The premises back onto a residential area of quiet gardens owned by families with young children and old people. Having people drinking, dancing, making music and noise until 2am 7 days a week is not acceptable, especially is this is taking place outside.

2 - The extended hours will also increase the noise pollution caused by people leaving the premises, in particular those rejoining cars parked at the Green Lanes end of Stanhope Gardens. At 2am, even a normal conversation taking place in the street will ruin the sleep of people in the houses nearby. The noise of doors closing, engine starting, cars reversing will be equally disturbing to those who live there.

3 - The mews area at the rear of Mezzo and adjacent shops is often littered with rubbish, empty, broken bottles and generally feels unsafe at night. The extended drinking hours will make this area even more unsafe and dirty.

Given the reasons expressed above, I object to the License being granted.

I also would also like to point out that the notice of the licensing application has not been posted outside the premises and that may invalidate the application on technical grounds.

Yours sincerely

Francois Ballay
7 Stanhope Gardens
London N4 1HY

07957 219877

This email has been scanned by the MessageLabs Email Security System.
For more information please visit <http://www.messagelabs.com/email>

Barrett Daliah

From: Phillip Kennedy [Phillip.Kennedy@int.sc.mufg.jp]
Sent: 10 March 2008 12:59
To: Barrett Daliah
Subject: Mezzo Cafe Late license opposition
Importance: High

Dear Daliah

I would like to lodge my strongest objection to the licensing application submitted by Mezzo Care, 64 Grand Parade.

As a resident of Stanhope Gardens (owner of No. 5), I believe such a plan by Mezzo would significantly impinge on the quality of life of the entire neighbourhood.

Already, we have a problem with anti-social behaviour on the corner of Stanhope Gardens and Grand Parade, and in the rear of the Mezzo Cafe. Encountering individuals, loitering, urinating, smoking, or consuming alcohol is a regular feature of my nightly return from work. This results in an intimidating environment for the women, children and elderly residents of the street.

As the rear of the Cafe backs directly onto the gardens of the homes along Stanhope Gardens, noise levels would be unacceptable.

Traffic and parking are already very congested in the area. This would be further exaggerated by the granting of a late night license.

In terms of the Cafe itself, I have seen some very disturbing examples of health violations from this establishment including: the preparation of unrefrigerated meat on a table, outside the rear of the premises; rotting food piling up outside the 'kitchen' door; a bag of rotting meat being dumped in my front lawn (upon investigation, similar bags of the same meat were piled at the back of the cafe).

Grand Parade has a fairly chequered past, and given the frequent changes of appearance and abuses of simple health guidelines by the owners of this establishment, I would be very disturbed if the Cafe were to be granted even further freedoms by the Haringey Council.

If you need clarification or further information regarding my opposition to this application, please do not hesitate to contact me.

Best regards

Phil Kennedy
5 Stanhope Gardens
N4 1HY

Phil Kennedy

Senior Market Analyst
Mitsubishi UFJ Securities International
Ph. +44 (0) 20 7577 2919
Mob. +44 (0) 790 999 8589
Phillip.Kennedy@int.sc.mufg.jp
philkennedy@bloomberg.net

Mitsubishi UFJ Securities International plc ("MUSI") is registered in England, company number

10/03/2008

1698498, registered office at 6 Broadgate, London EC2M 2AA, and is part of the Mitsubishi UFJ Financial Group. MUSI is authorised and regulated in the UK by The Financial Services Authority Limited (FSA). The information contained herein or attached hereto has been obtained from sources we believe to be reliable but we do not represent that it is accurate or complete and is not to be viewed as a 'personal recommendation' within the meaning of the FSA rules. The Information is not to be construed as an offer or solicitation to buy or sell any security, instrument or investment. Any reference to past performance should not be taken as an indication of future performance. MUSI or any affiliated company may have an interest, position, or effect transactions, in any investment mentioned herein. Any opinions or recommendations expressed herein are solely those of the author or analyst and are subject to change without notice. Neither MUSI nor any of its affiliates accept any liability whatsoever for any direct or consequential loss arising from any use of information or material contained herein.

This message is intended solely for the individual addressee named above. The information contained in this e-mail is confidential and may be legally privileged. If you are not the intended recipient, you must not copy, distribute or take any action in reliance on it. Messages sent via this medium may be subject to delays, non-delivery and unauthorised alteration.

This email has been scanned by the MessageLabs Email Security System.
For more information please visit <http://www.messagelabs.com/email>

Barrett Daliah

From: Viv [viv10@btconnect.com]
Sent: 11 March 2008 09:29
To: Barrett Daliah
Subject: MEZZO CAFE late night application
Importance: High

Dear Daliah

With regards to Mezzo applying for a late night application, I strongly object.

This is a residential area and myself and local residents have been arguing the same thing regarding Lakes for years

Apart from the noise, litter and other nuisance factors, we I am sure you are aware of, we, as long term residents NEED SLEEP.

Why were we not informed personally? Why did I find out about this application from a flyer posted throu my door?

I await your comments.

Yours sincerely

Vivien Inns-Mitchell
60B Grand Parade
Green Lanes
London
N4 1DZ
Tel: 07900 307 439

This email has been scanned by the MessageLabs Email Security System.
For more information please visit <http://www.messagelabs.com/email>

Karen J Alexander
139 Wightman Road London N8 0BB

27th February 2008

Daliah Barrett
Licensing Team
London Borough of Haringey
TechnoPark
Ashley Road
London
N17 9LN

Dear Ms Barrett

Mezzo (formerly Zig Zag or Roj), 64 Grand Parade, Green Lanes, London N4

The above establishment has put in a late-night application seeking to open until 2am daily but wants live and recorded music and dancing until 1.30am daily.

As a local resident I would like to object to such a licence being granted as I think the granting of such a licence would have very serious implications in relation to public nuisance, there would be increased noise, increased rubbish and litter and there is the potential for crime and disorder in the area. There are obviously also serious implications for residents living immediately above in Green Lanes and immediately behind in the Gardens road.

Yours sincerely



Karen Alexander

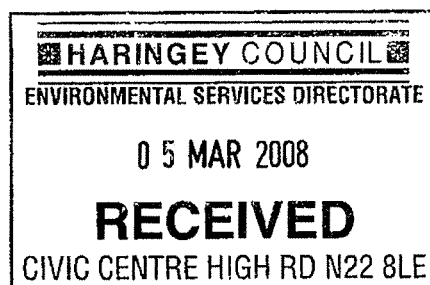

Barrett Daliah

From: Sarita Bansal [Sarita.Bansal@noveraenergy.com]
Sent: 10 March 2008 11:25
To: Barrett Daliah
Subject: Mezzo Cafe - late licence

Dear Daliah,

I am extremely concerned to hear of the late-licence application of the Mezzo Café (64 Grand Parade, Green Lanes N4).

As a house-owner on Stanhope Gardens, I would actually question whether management should be allowed to operate on their current basis, without extending the ill side-effects of their business. I frequently see uncooked meat left by the garage entrance at the back and there are nearly always kitchen staff lingering around the back smoking cigarettes and leaving butt ends on the ground. The level of hygiene is questionable and to suggest encouraging the additional nuisance of noise in a residential area surely will not be tolerated.

The idea that the establishment should be allowed to serve 'refreshments' until 2am is absolutely unacceptable and I assure you I will go to every length to block this application. Like many of my neighbours, I moved to this area to settle down and have children. It would be impossible to contain the noise levels of amplified live music proposed until 1.30am. For children and parents needing to sleep well before 11pm, this surely must be out of the question. It would be wholly anti-social and unfair on the local residents to allow the café to effectively become a nightclub on our doorsteps. We already have to cope with the disturbance of patrons lingering on the street which can be very unsettling after dark as it is. That is while the activities are supposedly contained inside, but we can at least block unnecessary, additional noise of evening drinkers outside, by our homes.

I am happy to say that so far, I have found Haringey Council to be very supportive and I do hope that you will not let us down on this occasion. We have the opportunity to maintain some dignity and respect for families in the area and I truly hope we will be listened to in this consultation process.

If you would like to discuss my absolute objection to this application at any stage, please do not hesitate to contact me. I will post a copy of this letter to you first class today with my signature. I would appreciate acknowledgement of my concerns and assurance that the rights of the residents will be taken as the first consideration in considering this application.

Kind regards,

Sarita
5 Stanhope Gardens
Haringey
London
N4 1HY

Sarita Bansal
Communications Manager
Novera Energy plc
30 Bedford Street
London WC2E 9ED
England

Mob +44 (0) 7866 453 366
Phone +44 (0) 20 7845 9720
Fax +44 (0) 20 7845 9721
E-mail sarita.bansal@noveraenergy.com
Web www.noveraenergy.com

10/03/2008

LATE-NIGHT LICENCE APPLICATION

Mezzo Cafe, 64 Grand Parade, Green Lanes N4

HARINGEY COUNCIL
ENVIRONMENTAL SERVICES DIRECTORATE

17 MAR 2008

We, the following undersigned residents:

strongly oppose the granting of a licence for live and recorded music, dancing and also any outside activity, particularly after midnight. This is on the grounds of potential noise nuisance to nearby residents, litter, traffic and anti-social behaviour.

RECEIVED
CIVIC CENTRE HIGH ST
LEAMINGTON

Date	Name (PRINT)	House Number	Name of Street	Signature
10/3/08	DR. WILLIAM HEAVEN	6	RUTLAND Gdns.	William Heaven
10/3/08	H ELMES	8	Rutland Gardens	H Elmes
10/3/08	Jill & John	10	Rutland Gdns	Jill & John
10/3/08	Mr C. Booth	1	"	C. Booth
10/3/08	MR J WIRTH	3	RUTLAND Gdns	J. Wirth
10/3/08	V. MADSIC-CONSTANTINOU	11	RUTLAND Gdns	V. Madsic-Constantinou
10/3/08	Yiannis Tsangaris	5	Rutland Gdns	Yiannis Tsangaris
10/3/08	Andriano Tsangaris	5	Rutland Gardens	Andriano Tsangaris
10-3-08	S. SIMIOU	2	"	S. Simiou
10-3-08	E Simiou	2	"	E. Simiou
11-3-08	VASILIOS CHRISTODOULOU	7	Rutland Gardens	V. Christodoulou
11-3-08	JULIA BELL	12	"	J. Bell
11/3/08	A. P. Panayi	16	Rutland Gdns	A. P. Panayi
11/3/08	T. Jones	19	Rutland Gdns	T. Jones
11/3/08	G. G. G.	24	Rutland Gdns	G. G. G.
11/3/08	Therese	9	Rutland Gdns	Therese
11/3/08	Circle	15A	Rutland Gdns	Circle
11/03/08	MARIE CORCORAN	60 ^C	GRAND PARADE	Marie Corcoran
11/3/08	SHALIA ASLAM	60A	"	Shalia Aslam
11.03.08	Mr + Mrs R MARCHANT	23	Rutland Gardens	R. Marchant
11/03/08	ICellanovos	56C	Grand Parade	ICellanovos
11/03/08	RHIANNON WILLIAMS	56c	Grand Parade	Rhiannon Williams
11/03/08	LAURA JOLLEY	56C	Grand Parade	L. Jolley
11/03/08	Olga Philippou	4	RUTLAND Gdns	Olga Philippou

LATE-NIGHT LICENCE APPLICATION

Mezzo Cafe, 64 Grand Parade, Green Lanes N4

We, the following undersigned residents:
strongly oppose the granting of a licence for live and recorded music, dancing and also any outside activity, particularly after midnight. This is on the grounds of potential noise nuisance to nearby residents, litter, traffic and anti-social behaviour.

Date	Name (PRINT)	House Number	Name of Street	Signature
11.03.08	Maria B. Moposita	1	Stanhope Gdns	
11/03/08	ANDREW BICKLEY	3	STANHOPE Gdns	
11/03/08	FRANCIS BAUMY	7	STANHOPE Gdns	
11/3/08	ANNETTE EUGEN	7	stanhope Gdns	
11/3/08	JOHN ANDERSON	9	STANHOPE Gdns	
11/01/08	LINDSEY SULLIVAN	17	Stanhope Gdns	
11.03.08	SHARIF AHMED	25	STANHOPE Gdns	
11.03.08	CISSE KATUMBA	27	stanhope Gdns	
11-03-08	SEBASTIAO NASCIMENTO	29A	STANHOPE GARDENS	
11/03/08	DA PEREIRA	26	STANHOPE Gdns	
11/3/08	Mrs Y.Y. NAYANMOR	24B	Stanhope Gdns	
11-3-08	Doreen Nicholas	22	Stanhope Gdns	
11-3-8	Priya Nicholas	22	Stanhope Gardens	
11	Luz Whitmore	18	" "	
11-3-08	B. J. DERBYSHIRE	6	STANHOPE GARDENS	
11/3/08	DAVID CARNEGIE	30	RUTLAND GARDENS	
11/3/08	Etem Markou	28	Rutland Gdns	
11/3/08	GEORGE MARKOU	28	Rutland Gdns	
11/3/08	Sandra Da Silva	26	Rutland Gdns	
11/3/08	Profu.	51	" "	
11	BRIDEN	51	" "	
12.03.08	SEAN	5	Stanhope	

APP 3

COPY OF CURRENT LICENSE

LICENSING ACT 2003
Section 24

PREMISES LICENCE

Receipt: AG766688

Premises Licence Number: LN00002130,
LN000002922

This Premises Licence has been issued by:
**The Licensing Authority, London Borough of Haringey,
Civic Centre, High Road, Wood Green,
London, N22 8LE**

Signature:

Date: 24TH November 2005,
1st February 2008

Part 1 – PREMISES DETAILS

Postal Address of Premises or, if none, Ordnance Survey map reference or description:

**ROJ
64 GRAND PARADE
GREEN LANES
LONDON
N4 1AF**

Telephone: 07940 923792

Where the Licence is time limited, the dates:

N/A

Licensable activities authorised by the Licence:

Provision of Late Night Refreshment

The times the Licence authorises the carrying out of licensable activities:

Provision of Late Night Refreshment

Monday to Sunday 2300 to 0200

LICENSING ACT 2003

Sec 24

The opening hours of the premises:

Monday to Sunday 1000 to 0200

Where the Licence authorises supplies of alcohol whether these are on and/or off supplies:

No supply of alcohol permitted on this premises.

Part 2

Name, (registered) address, telephone number and e-mail (where relevant) of holder of Premises Licence:

Mr Suleyman Aksoy
Flat 5
155A Fore Street
Edmonton
London N18 2XB

Registered number of holder, for example company number, charity number (where applicable):

Name, address and telephone number of designated premises supervisor where the Premises Licence authorises the supply of alcohol:

Personal Licence number and issuing authority of personal licence held by designated premises supervisor where the Premises Licence authorises for the supply of alcohol:

Annex 1 –Mandatory Conditions

Annex 2 – Conditions consistent with the Operating Schedule

THE PREVENTION OF CRIME AND DISORDER

PUBLIC SAFETY

Premises will have fire extinguishers, a fire blanket, emergency lighting, heat detector and fire doors.

Premises will display the relevant signage as to fire exits, etc.

Maximum number of persons permitted on the premises (including staff) 60

THE PREVENTION OF PUBLIC NUISANCE

THE PROTECTION OF CHILDREN

Annex 3 – Conditions attached after a hearing by the licensing authority

Annex 4 - Plans

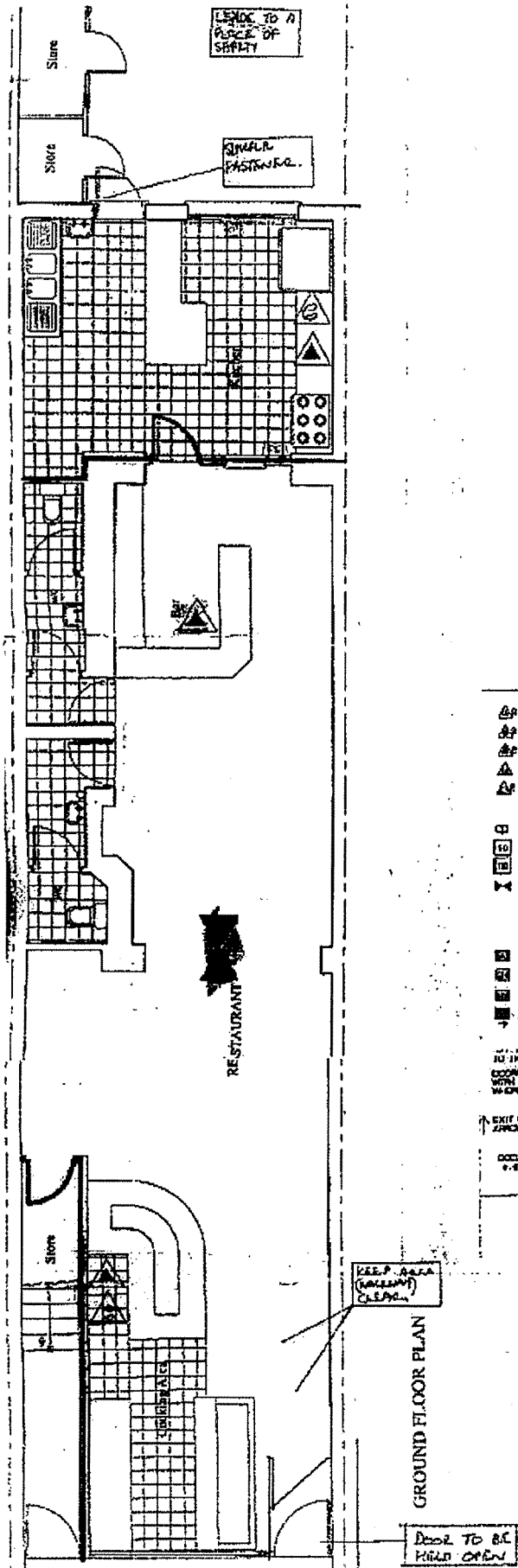

- RECOMMENDED LEGEND ON SUITABLE EQUIPMENT

	8 LITRE WATER EXTINGUISHER
	8 LITRE FOAM EXTINGUISHER
	8 KG CARBON DIOXIDE EXTINGUISHER
	FIRE BLANKET
	8 KG DRY POWDER
	FIRE ALARM CALL POINT (BS. 5838)
	AREA COVERED BY SMOKE DETECTOR (BS. 5839)
	AREA COVERED BY HEAT DETECTOR (BS. 5839)
	AREA COVERED BY EMERGENCY LIGHTING (BS. 5839)
CERTIFICATE OF COMPLIANCE TO BS. 5839 (FIRE ALARMS) AND / OR BS. 5839 (EMERGENCY LIGHTING) TO BE PROVIDED TO THE FIRE AUTHORITY	
	SIGN - " FIRE DOOR KEEP SHUT " - 80mm LETTERS - BOTH SIDES OF DOOR
	SIGN - " FIRE DOOR KEEP LOCKED " - 80mm LETTERS
	SIGN - " SECURE OPEN WASH HANDS ARE OCCUPIED " - 80mm LETTERS
	SIGN - " FIRE EXIT " OF SUITABLE SIZE - 80mm LETTERS. DIRECTIONAL ARROW TO BE PROVIDED BY THE MANUFACTURER.
<p>IN THE CASE OF UP-PURPOSE EQUIPMENT:</p> <p>EQUIPMENT INCLUDING EMERGENCY LIGHTING TO BE TESTED & INSTALLED IN ACCORDANCE WITH THE CURRENT BRITISH STANDARDS BS. 5839 (BS. 5839) SECTION 21.1 WHERE THE " S " SPECIFICATION REQUIRES (SHOCK STOPPING).</p> <p>EXIT WIDTHS AND SPACINGS TO CONFORM TO BS. 5839, PT. 2 OR PT. 3 AS APPROPRIATE, VIZ. 0.9M MIN AREA.</p> <p>OCCUPATION DENSITIES TO BS. 5839, PT. 2 OR PT. 3 AS APPROPRIATE, VIZ. 0.30M² PER PERSON.</p>	

GROUND FLOOR PLAN

This page is intentionally left blank

Licensing Act 2003 Sub-Committee on 02nd APRIL 2008

Report title: Application for a new Premises Licence at GRILL KEBAB HOUSE, 270 MUSWELL HILL, LONDON N10 2QR

Report of: The Lead Officer Licensing

Ward(s) affected MH

1. Purpose

To consider an application by MR HATEM KOC to allow Late Night Refreshment at the above premises.

2. Recommendations

- 2.1 (a) Grant the application as asked
 (b) Modify the conditions of the licence, by altering or omitting or adding to them
 (c) Reject the whole or part of the application

The Committee is asked to note that it may not modify the conditions or reject the whole or part of the application unless it is necessary to promote the licensing objectives.

Report authorised by: Robin Payne.....



Assistant Director Enforcement Services

Contact Officer: Ms Daliah Barrett -Williams

Telephone: 020 8489 8232

3. Executive summary

For consideration by Sub Committee under Licensing Act 2003 for a Premises licence with variation to the existing conditions

4. Access to information:

Local Government (Access to Information) Act 1985

Background Papers

The following Background Papers are used in the preparation of this Report:

File: GRILL KEBAB HOUSE

The Background Papers are located at Enforcement Service, Civic Centre, High Road Wood Green N22

This page is intentionally left blank

5. REPORT**Background**

5.1 An application for a new Premises Licence, by Mr Hatem Koc in respect of Grill Kebab House, 270 Muswell Hill Broadway, London N10 2QR under the Licensing Act 2003.

5.2 **Details of the application being sought under a new Premises Licence APP1**

Opening Hours for Public

Sunday & Monday 08:00-02:30

Tuesday to Saturday 08:00-04:00

Provision of Late Night Refreshment

Sunday & Monday 23:00-02:30

Tuesday to Saturday 23:00-04:00

General-all four licensing objectives

The standard practices listed below will be maintained at all times. All reasonable steps will be taken to ensure that the premises will have a positive impact upon the local environment and its residents at all times.

5.3 Crime and Disorder

1 SIA DOORSTAFF EMPLOYED FROM 23:00 until closing time on Fridays and Saturdays to disperse people leaving from the premises.

CCTV system shall be installed and maintained inside and outside the premises, including a CCTV unit, which monitors the immediate vicinity of the premises. All cameras shall continually record whilst the premises are open to the public and the recordings shall be kept available for a minimum of 31 days with time and date stamping. Recordings shall be made available to an authorised officer or a Police Officer within 24 hours of any request.

5.4 Public Safety

Appropriate Fire Safety Procedures are in place along with appliances including fire extinguishers (Foam, H2O and CO2), fire blankets, internally illuminated fire exit signs, a smoke detector and emergency lighting. All appliances are checked annually and comply with relevant British Standards.

All fire escapes/ escapes routes will be clearly marked and kept free from obstructions at all times.

5.5 Public Nuisance

All customers are asked to respect the surroundings and behave in an orderly manner.

Signs will be installed to remind customers respect neighbours and leave quietly.

Patrons will be discouraged from congregating outside the premises.

All waste generated by the premises will be dealt with appropriately.

5.6 Child Protection

6. RELEVANT REPRESENTATIONS (CONSULTATION)

Responsible authorities:

6.1 Comments of Metropolitan Police – APP 2

The Police have made representation regarding this application and are requesting that 2 SIA doormen are employed from 22.00 to close of business to monitor the entry and exit of customers.

6.2 Comments of Enforcement Services:

Noise Team

Have made objections to this application – APP 3

Food Team

Have no objections to this application.

Health and Safety

Have made recommendations regarding this application – APP 4

Trading Standards

Have no objections to this application

6.3 Fire Officer

Have no objections to this application

6.4 Planning Officer

Have no objections to this application

6.5 Comments of Child Protection Agency or Nominee

No representation made on this matter

7.0 Interested Parties

Have no objection to this application

8.0 Financial Comments

The fee which would be applicable for this application was **£190.00**

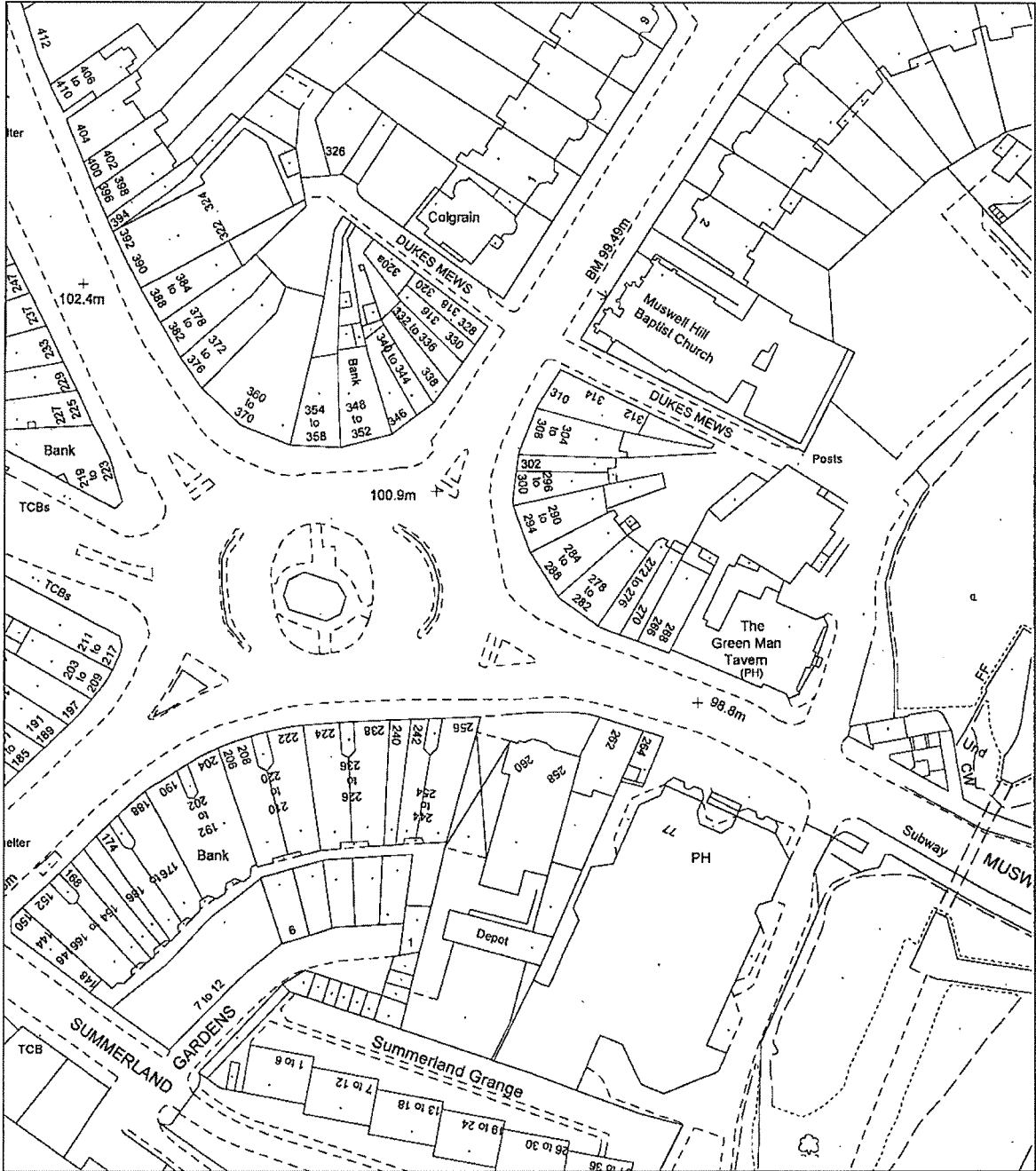

Reproduced from the Ordnance Survey mapping with the permission of the Controller of Her Majesty's Stationery Office. © Crown copyright. Unauthorised reproduction infringes crown copyright and may lead to prosecution or civil proceedings. LB Haringey LA080401 2004

Site plan

Gill Kebab House, 270 Muswell Hill Broadway N10

HARINGEY COUNCIL
Directorate of Environmental Services

Robin Payne
 Assistant Director
 Enforcement Service
 639 High Road
 London N17 8BD
 Tel 020 8489 0000
 Fax 020 8489 5525

	Drawn by	DW
	Scale	1:1000
	Date	19/03/2008

APP 1

APPLICATION FORM

**Application for a premises licence to be granted
 under the Licensing Act 2003**

PLEASE READ THE FOLLOWING INSTRUCTIONS FIRST

Before completing this form please read the guidance notes at the end of the form.
 If you are completing this form by hand please write legibly in block capitals. In all cases ensure that your answers are inside the boxes and written in black ink. Use additional sheets if necessary.
 You may wish to keep a copy of the completed form for your records.

I/We MR HATEM KOC

(Insert name(s) of applicant)

apply for a premises licence under section 17 of the Licensing Act 2003 for the premises described in Part 1 below (the premises) and I/we are making this application to you as the relevant licensing authority in accordance with section 12 of the Licensing Act 2003

Part 1 – Premises Details

Postal address of premises or, if none, Ordnance Survey map reference or description GRILL KEBAB HOUSE 270 MUSWELL HILL BROADWAY		HARINGEY COUNCIL ENVIRONMENTAL SERVICES DIRECTORATE 15 FEB 2008 RECEIVED CIVIC CENTRE HIGH RD N22 8LE	
Post town	London	Post code	N10 2QR

Telephone number at premises (if any)	
Non-domestic rateable value of premises	£9200

Part 2 - Applicant Details

Please state whether you are applying for a premises licence as
 Please tick yes

- a) an individual or individuals * please complete section (A)
- b) a person other than an individual *
 - i. as a limited company please complete section (B)
 - ii. as a partnership please complete section (B)
 - iii. as an unincorporated association or please complete section (B)
 - iv. other (for example a statutory corporation) please complete section (B)
- c) a recognised club please complete section (B)
- d) a charity please complete section (B)

HARINGEY COUNCIL ENVIRONMENTAL SERVICES DIRECTORATE 15 FEB 2008 RECEIVED CIVIC CENTRE HIGH RD N22 8LE	
--	--

- e) the proprietor of an educational establishment please complete section (B)
- f) a health service body please complete section (B)
- g) a person who is registered under Part 2 of the Care Standards Act 2000 (c14) in respect of an independent hospital please complete section (B)
- h) the chief officer of police of a police force in England and Wales please complete section (B)

* If you are applying as a person described in (a) or (b) please confirm:

Please tick yes

- I am carrying on or proposing to carry on a business which involves the use of the premises for licensable activities; or
- I am making the application pursuant to a
 - statutory function or
 - a function discharged by virtue of Her Majesty's prerogative

(A) INDIVIDUAL APPLICANTS (fill in as applicable)

Mr <input checked="" type="checkbox"/>	Mrs <input type="checkbox"/>	Miss <input type="checkbox"/>	Ms <input type="checkbox"/>	Other Title (for example, Rev)	
Surname KOC			First names HATEM		
I am 18 years old or over				<input checked="" type="checkbox"/> Please tick yes	
Current postal address if different from premises address		Flat 59, Hawkinge, Gloucester Road			
Post Town	London		Postcode	N17 6LP	
Daytime contact telephone number					
E-mail address (optional)					

SECOND INDIVIDUAL APPLICANT (if applicable)

Mr <input type="checkbox"/>	Mrs <input type="checkbox"/>	Miss <input type="checkbox"/>	Ms <input type="checkbox"/>	Other Title (for example, Rev)	
Surname			First names		
I am 18 years old or over				<input type="checkbox"/> Please tick yes	

Current postal address if different from premises address			
Post Town		Postcode	
Daytime contact telephone number			
E-mail address (optional)			

(B) OTHER APPLICANTS

Please provide name and registered address of applicant in full. Where appropriate please give any registered number. In the case of a partnership or other joint venture (other than a body corporate), please give the name and address of each party concerned.

Name
Address
Registered number (where applicable)
Description of applicant (for example, partnership, company, unincorporated association etc.)
Telephone number (if any)
E-mail address (optional)

Part 3 Operating Schedule

When do you want the premises licence to start?

Day		Month		Year	
1	6	0	3	2	0
0	8				

If you wish the licence to be valid only for a limited period, when do you want it to end?

Day		Month		Year	

Please give a general description of the premises (please read guidance note1)
 The premises is used as takeaway. Please refer to the enclosed plan.

If 5,000 or more people are expected to attend the premises at any one time, please state the number expected to attend.

What licensable activities do you intend to carry on from the premises?

(Please see sections 1 and 14 of the Licensing Act 2003 and Schedules 1 and 2 to the Licensing Act 2003)

Provision of regulated entertainment

Please tick yes

- a) plays (if ticking yes, fill in box A)
- b) films (if ticking yes, fill in box B)
- c) indoor sporting events (if ticking yes, fill in box C)
- d) boxing or wrestling entertainment (if ticking yes, fill in box D)
- e) live music (if ticking yes, fill in box E)
- f) recorded music (if ticking yes, fill in box F)
- g) performances of dance (if ticking yes, fill in box G)
- h) anything of a similar description to that falling within (e), (f) or (g) (if ticking yes, fill in box H)

Provision of entertainment facilities:

- i) making music (if ticking yes, fill in box I)
- j) dancing (if ticking yes, fill in box J)
- k) entertainment of a similar description to that falling within (i) or (j) (if ticking yes, fill in box K)

Provision of late night refreshment (if ticking yes, fill in box L)

Supply of alcohol (if ticking yes, fill in box M)

In all cases complete boxes N, O and P

A

Plays Standard days and timings (please read guidance note 6)			Will the performance of a play take place indoors or outdoors or both – please tick (please read guidance note 2)	Indoors	<input type="checkbox"/>
Day	Start	Finish		Outdoors	<input type="checkbox"/>
Mon			Please give further details here (please read guidance note 3)	Both	<input type="checkbox"/>
Tue					
Wed			State any seasonal variations for performing plays (please read guidance note 4)		
Thur					
Fri			Non standard timings. Where you intend to use the premises for the performance of plays at different times to those listed in the column on the left, please list (please read guidance note 5)		
Sat					
Sun					

B

Films Standard days and timings (please read guidance note 6)			Will the exhibition of films take place indoors or outdoors or both – please tick (please read guidance note 2)	Indoors	<input type="checkbox"/>
				Outdoors	<input type="checkbox"/>
				Both	<input type="checkbox"/>
Day	Start	Finish	Please give further details here (please read guidance note 3)		
Mon					
			State any seasonal variations for the exhibition of films (please read guidance note 4)		
Tue					
			Non standard timings. Where you intend to use the premises for the exhibition of films at different times to those listed in the column on the left, please list (please read guidance note 5)		
Wed					
Thur					
Fri					
Sat					
Sun					

C

Indoor sporting events Standard days and timings (please read guidance note 6)			Please give further details (please read guidance note 3)
Day	Start	Finish	
Mon			
Tue			State any seasonal variations for indoor sporting events (please read guidance note 4)
Wed			Non standard timings. Where you intend to use the premises for indoor sporting events at different times to those listed in the column on the left, please list (please read guidance note 5)
Thur			
Fri			
Sat			
Sun			

D

Boxing or wrestling entertainments Standard days and timings (please read guidance note 6)			Will the boxing or wrestling entertainment take place indoors or outdoors or both – please tick (please read guidance note 2)	Indoors	<input type="checkbox"/>
				Outdoors	<input type="checkbox"/>
				Both	<input type="checkbox"/>
Day	Start	Finish	Please give further details here (please read guidance note 3)		
Mon					
			State any seasonal variations for boxing or wrestling entertainment (please read guidance note 4)		
Tue					
			Non standard timings. Where you intend to use the premises for boxing or wrestling entertainment at different times to those listed in the column on the left, please list (please read guidance note 5)		
Wed					
Thur					
Fri					
Sat					
Sun					

E

Live music Standard days and timings (please read guidance note 6)			Will the performance of live music take place <u>indoors or outdoors or both – please tick</u> (please read guidance note 2)	Indoors	<input type="checkbox"/>
Day	Start	Finish		Outdoors	<input type="checkbox"/>
Mon			Please give further details here (please read guidance note 3)	Both	<input type="checkbox"/>
Tue					
Wed			State any seasonal variations for the performance of live music (please read guidance note 4)		
Thur					
Fri			Non standard timings. Where you intend to use the premises for the performance of live music at different times to those listed in the column on the left, please list (please read guidance note 5)		
Sat					
Sun					

F

Recorded music Standard days and timings (please read guidance note 6)			<u>Will the playing of recorded music take place indoors or outdoors or both – please tick</u> (please read guidance note 2)	Indoors	<input type="checkbox"/>
				Outdoors	<input type="checkbox"/>
				Both	<input type="checkbox"/>
Day	Start	Finish			
Mon			<u>Please give further details here</u> (please read guidance note 3)		
Tue					
Wed			<u>State any seasonal variations for the playing of recorded music</u> (please read guidance note 4)		
Thur					
Fri			<u>Non standard timings. Where you intend to use the premises for the playing of recorded music at different times to those listed in the column on the left, please list</u> (please read guidance note 5)		
Sat					
Sun					

G

Performances of dance Standard days and timings (please read guidance note 6)			<u>Will the performance of dance take place indoors or outdoors or both – please tick</u> (please read guidance note 2)	Indoors	<input type="checkbox"/>
				Outdoors	<input type="checkbox"/>
				Both	<input type="checkbox"/>
Day	Start	Finish	<u>Please give further details here</u> (please read guidance note 3)		
Mon					
Tue			<u>State any seasonal variations for the performance of dance</u> (please read guidance note 4)		
Wed					
Thur			<u>Non standard timings. Where you intend to use the premises for the performance of dance at different times to those listed in the column on the left, please list</u> (please read guidance note 5)		
Fri					
Sat					
Sun					

H

<p>Anything of a similar description to that falling within (e), (f) or (g) Standard days and timings (please read guidance note 6)</p>			<p><u>Please give a description of the type of entertainment you will be providing</u></p>		
Day	Start	Finish	<p><u>Will this entertainment take place indoors or outdoors or both – please tick</u> (please read guidance note 2)</p>	Indoors	<input type="checkbox"/>
Mon				Outdoors	<input type="checkbox"/>
				Both	<input type="checkbox"/>
Tue			<p><u>Please give further details here</u> (please read guidance note 3)</p>		
Wed					
Thur					
Fri			<p><u>State any seasonal variations for entertainment of a similar description to that falling within (e), (f) or (g)</u> (please read guidance note 4)</p>		
Sat			<p><u>Non standard timings. Where you intend to use the premises for the entertainment of a similar description to that falling within (e), (f) or (g) at different times to those listed in the column on the left, please list</u> (please read guidance note 5)</p>		
Sun					

I

Provision of facilities for making music Standard days and timings (please read guidance note 6)			<u>Please give a description of the facilities for making music you will be providing</u>		
			<u>Will the facilities for making music be indoors or outdoors or both – please tick</u> (please read guidance note 2)		Indoors
			Outdoors	<input type="checkbox"/>	
			Both	<input type="checkbox"/>	
Day	Start	Finish	<u>Please give further details here</u> (please read guidance note 3)		
Mon					
Tue			<u>State any seasonal variations for the provision of facilities for making music</u> (please read guidance note 4)		
Wed					
Thur			<u>Non standard timings. Where you intend to use the premises for provision of facilities for making music at different times to those listed in the column on the left, please list</u> (please read guidance note 5)		
Fri					
Sat					
Sun					

J

Provision of facilities for dancing Standard days and timings (please read guidance note 6)			<u>Will the facilities for dancing be indoors or outdoors or both – please tick</u> (see guidance note 2)	Indoors <input type="checkbox"/>
				Outdoors <input type="checkbox"/>
				Both <input type="checkbox"/>
Day	Start	Finish	<u>Please give a description of the facilities for dancing you will be providing</u>	
Mon			<u>Please give further details here</u> (please read guidance note 3)	
Tue				
Wed			<u>State any seasonal variations for providing dancing facilities</u> (please read guidance note 4)	
Thur				
Fri			<u>Non standard timings. Where you intend to use the premises for the provision of facilities for dancing entertainment at different times to those listed in the column on the left, please list</u> (please read guidance note 5)	
Sat				
Sun				

K

Provision of facilities for entertainment of a similar description to that falling within i or j Standard days and timings (please read guidance note 6)			<u>Please give a description of the type of entertainment facility you will be providing</u>		
Day	Start	Finish	<u>Will the entertainment facility be indoors or outdoors or both – please tick</u> (please read guidance note 2)	Indoors	<input type="checkbox"/>
Mon				Outdoors	<input type="checkbox"/>
				Both	<input type="checkbox"/>
Tue			<u>Please give further details here</u> (please read guidance note 3)		
Wed					
Thur			<u>State any seasonal variations for the provision of facilities for entertainment of a similar description to that falling within i or j</u> (please read guidance note 4)		
Fri					
Sat			<u>Non standard timings. Where you intend to use the premises for the provision of facilities for entertainment of a similar description to that falling within i or j at different times to those listed in the column on the left, please list</u> (please read guidance note 5)		
Sun					

L

Late night refreshment Standard days and timings (please read guidance note 6)			Will the provision of late night refreshment take place indoors or outdoors or both – please tick (please read guidance note 2)	Indoors	<input checked="" type="checkbox"/>
				Outdoors	<input type="checkbox"/>
				Both	<input type="checkbox"/>
Day	Start	Finish			
Mon	23:00	02:30	Please give further details here (please read guidance note 3)		
Tue	23:00	04:00			
Wed	23:00	04:00	State any seasonal variations for the provision of late night refreshment (please read guidance note 4) N/A		
Thur	23:00	04:00			
Fri	23:00	04:00	Non standard timings. Where you intend to use the premises for the provision of late night refreshment at different times, to those listed in the column on the left, please list (please read guidance note 5) N/A		
Sat	23:00	04:00			
Sun	23:00	02:30			

M

Supply of alcohol Standard days and timings (please read guidance note 6)			Will the supply of alcohol be for consumption (Please tick box) (please read guidance note 7)	On the premises <input type="checkbox"/>
				Off the premises <input type="checkbox"/>
				Both <input type="checkbox"/>
Day	Start	Finish	State any seasonal variations for the supply of alcohol (please read guidance note 4)	
Mon				
Tue				
Wed				
Thur				
Fri				
Sat				
Sun			Non standard timings. Where you intend to use the premises for the supply of alcohol at different times to those listed in the column on the left, please list (please read guidance note 5)	

State the name and details of the individual whom you wish to specify on the licence as premises supervisor

Name	
Address	
Postcode	
Personal Licence number (if known)	
Issuing licensing authority (if known)	

N

Please highlight any adult entertainment or services, activities, other entertainment or matters ancillary to the use of the premises that may give rise to concern in respect of children (please read guidance note 8)
 N/A

O

Hours premises are open to the public Standard days and timings (please read guidance note 6)			State any seasonal variations (please read guidance note 4) N/A
Day	Start	Finish	Non standard timings. Where you intend the premises to be open to the public at different times from those listed in the column on the left, please list (please read guidance note 5) N/A
Mon	08:00	02:30	
Tue	08:00	04:00	
Wed	08:00	04:00	
Thur	08:00	04:00	
Fri	08:00	04:00	
Sat	08:00	04:00	
Sun	08:00	02:30	

P Describe the steps you intend to take to promote the four licensing objectives:

a) General – all four licensing objectives (b,c,d,e) (please read guidance note 9)

The standard practices listed below will be maintained at all times. All reasonable steps will be taken to ensure that the premises will have a positive impact upon the local environment and its residents at all times.

b) The prevention of crime and disorder

1 SIA DOORSTAFF EMPLOYED FROM 23:00 until closing time on Fridays and Saturdays to disperse people leaving from the premises.

CCTV system shall be installed and maintained inside and outside the premises, including a CCTV unit, which monitors the immediate vicinity of the premises. All cameras shall continually record whilst the premises are open to the public and the recordings shall be kept available for a minimum of 31 days with time and date stamping. Recordings shall be made available to an authorised officer or a police officer with 24 hours of any request

c) Public safety

Appropriate fire safety procedures are in place along with appliances including fire extinguishers (Foam, H2O and CO2), fire blankets, internally illuminated fire exit signs, a smoke detector and emergency lighting. All appliances are checked annually and comply with relevant British Standards.

All fire escapes/escape routes will be clearly marked and kept free from obstructions at all times.

d) The prevention of public nuisance

All customers are asked to respect the surroundings and behave in an orderly manner.

Signs will be installed to remind customers respect neighbours and leave quietly.

Patrons will be discouraged from congregating outside the premises.

All waste generated by the premises will be dealt with appropriately.

e) The protection of children from harm

n/a

Please tick yes

- I have made or enclosed payment of the fee
- I have enclosed the plan of the premises
- I have sent copies of this application and the plan to responsible authorities and others where applicable
- I have enclosed the consent form completed by the individual I wish to be premises supervisor, if applicable
- I understand that I must now advertise my application
- I understand that if I do not comply with the above requirements my application will be rejected

IT IS AN OFFENCE, LIABLE ON CONVICTION TO A FINE UP TO LEVEL 5 ON THE STANDARD SCALE, UNDER SECTION 158 OF THE LICENSING ACT 2003 TO MAKE A FALSE STATEMENT IN OR IN CONNECTION WITH THIS APPLICATION

Part 4 – Signatures (please read guidance note 10)

Signature of applicant or applicant’s solicitor or other duly authorised agent (See guidance note 11). **If signing on behalf of the applicant please state in what capacity.**

Signature	
Date	14 th February 2008
Capacity	Authorised Agent

For joint applications signature of 2nd applicant or 2nd applicant’s solicitor or other authorised agent. (please read guidance note 12). **If signing on behalf of the applicant please state in what capacity.**

Signature	
Date	
Capacity	

Contact name (where not previously given) and postal address for correspondence associated with this application (please read guidance note 13) Stevans Allen 90 Green Lanes			
Post town	London	Post code	N16 9EJ
Telephone number (if any)			
If you would prefer us to correspond with you by e-mail your e-mail address (optional) We accept correspondence by letter only			

Notes for Guidance

1. Describe the premises. For example the type of premises, its general situation and layout and any other information which could be relevant to the licensing objectives. Where your application includes off-supplies of alcohol and you intend to provide a place for consumption of these off-supplies you must include a description of where the place will be and its proximity to the premises.
2. Where taking place in a building or other structure please tick as appropriate. Indoors may include a tent.
3. For example the type of activity to be authorised, if not already stated, and give relevant further details, for example (but not exclusively) whether or not music will be amplified or unamplified.
4. For example (but not exclusively), where the activity will occur on additional days during the summer months.
5. For example (but not exclusively), where you wish the activity to go on longer on a particular day e.g. Christmas Eve.
6. Please give timings in 24 hour clock (e.g. 16:00) and only give details for the days of the week when you intend the premises to be used for the activity.
7. If you wish people to be able to consume alcohol on the premises please tick on, if you wish people to be able to purchase alcohol to consume away from the premises please tick off. If you wish people to be able to do both please tick both.
8. Please give information about anything intended to occur at the premises or ancillary to the use of the premises which may give rise to concern in respect of children, regardless of whether you intend children to have access to the premises, for example (but not exclusively) nudity or semi-nudity, films for restricted age groups, the presence of gaming machines.
9. Please list here steps you will take to promote all four licensing objectives together.
10. The application form must be signed.
11. An applicant's agent (for example solicitor) may sign the form on their behalf provided that they have actual authority to do so.
12. Where there is more than one applicant, both applicants or their respective agents must sign the application form.
13. This is the address which we shall use to correspond with you about this application.

APP 2

REPRESENTATION FROM POLICE



Your reference:

Our reference: 47/2008

Date: 21 February, 2008

Metropolitan Police Service

Ms D.BARRETT
ENVIRONMENTAL CONTROL SERVICES
TECHNO PARK
ASHLEY ROAD
TOTTENHAM N.17

Licensing
Wood Green Police Station
347 High Road
Wood Green
N.22 4HZ

Tel: 0208 – 345 -2005

Dear Ms. Barrett

Re:- Application for a Premises Licence:-

Grill Kebab House, 270 Muswell Hill Broadway N.10.

With reference to the above application Police have considered the application and wish to make the following representations.

1.This is under the Prevention of Crime & Disorder.

We request that a minimum of two SIA registered doorstaff be employed from 22.00 to close of business to monitor the entry and exit of customers.

That the CCTV be a digital system.

Yours Sincerely

A handwritten signature in black ink, appearing to read "Geoffrey Parker".

Geoffrey Parker
Licensing
Wood Green Police Station

c.c.Act 2003



APP 3

REPRESENTATION FROM NOISE TEAM



Haringey Council

Licensing Consultation - Internal Memo

To: Licensing Officer

From: Derek Pearce Enforcement Response Officer (Noise)

Our Reference WK65326

Date: 12th March 2008

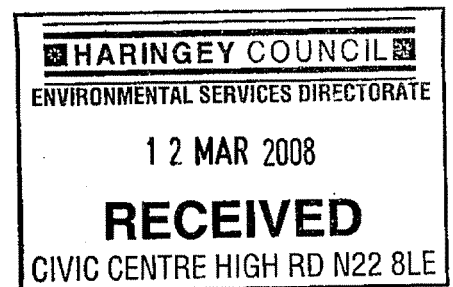

Premises: GRILL Kebab House, 270 Muswell Hill, Broadway, London, N10 2QR

Type of application: Variation

I would like to confirm that I have considered the above proposal with regard to the prevention of public nuisance on behalf of the Enforcement Response (Noise) Team & would like to:

Make representations to the Variation.

on the following grounds :

That the proposed operating hours are inappropriate due to the close proximity of residential dwellings. The noise caused by patrons exiting the premises, loitering in and around the premises and locating suitable transport home is likely to be detrimental to the residential amenity. This is not helped by the level of public transport available at the proposed closing hours.

The operating schedule does not adequately address the prevention of public nuisance from:

- Noise generated from patrons who may be queuing to enter
- Noise from patrons exiting the premises and who may loiter in the area
- Noise generated from deliveries and/or patrons collecting goods in early hours of the morning.
- Noise from plant and machinery
- Litter nuisance

Supporting Information

Later opening hours may encourage patrons of other premises nearby to loiter, outside or nearby, causing a noise nuisance to local residents. This may aggravate public safety and nuisance, in the immediate area, by patrons of other nearby venues causing public order offence. The present management of these premises don't appear to be able to run the premises according to present licensing conditions and have been reported for being open past their current operating hours and have not complied with the terms of Temporary Event Notices which they have put in

Informative

We would recommend the following alterations/conditions to the operating schedule:

Operating hours

That the premises closes for new business no later than 02.00 Sunday to Thursday (03.00 on Friday and Saturday nights ie Saturday and Sunday early mornings), any patron sitting down in premises to vacate within 30 minutes of the closing time.

That an SIA approved door person be employed from midnight until closing on Friday and Saturday nights.

**Prevention of nuisance from noise/vibration
Airborne**

Adequate and suitable mechanical ventilation should be provided to public areas

Sound limits

No music to be played in the premises other than background music which does not intrude into conversations

Patrons entering/exiting premises.

When the premises turn out a licensed door supervisor (or the proprietor if no licensed door supervisor required on that day) shall supervise patrons and ensure they leave in a prompt and courteous manor, respecting the neighbours

Signs should be displayed instructing patrons to respect the neighbours and behave in a courteous manor

Prevention of Nuisance from Odour

All ventilation and extraction systems shall be correctly maintained and regularly serviced to ensure that it is operating efficiently and with minimal disturbance to neighbours arising from odour

Prevention of nuisance from light

Illuminated external signage shall be switched off when the premises is closed

Security lights will be positioned to minimise light intrusion to nearby residential premises

Derek Pearce
Out of Hours Response (Noise) Officer

APP 4

REPRESENTATION FROM HEALTH AND SAFETY
TEAM

Barrett Daliah

From: Turner Ilita
Sent: 25 February 2008 10:15
To: Barrett Daliah
Subject: LIC Grill Kebab House 270 Muswell Hill Broadway N10.htm



Grill Kebab House,
270 Muswell Hill Broadway,
Muswell Hill London N10 2OR

APPLICATION FOR A PREMISES LICENCE

Please attach the following enforcement conditions to the above-mentioned licensing application:-

Odour coming from late night takeaways

- Ensure the relevant planning controls have not been breached.
- Ensure the odour does not build up with the use of equipment such as extractor fans.

Odour from waste and bottle storage areas:

- Ensure waste is collected on a regular basis by a reputable/licensed waste carrier.
- Use a regular cleaning programme for all storage areas and waste bins.
- Screen off waste storage areas from sight and making sure the area can be properly cleaned and has adequate drainage.
- Ensure sealed waste bins used are big enough to hold all waste and can be thoroughly cleaned.

Odour coming from blocked and inadequately vented drainage systems:

- Ensure food waste is not put into the drainage system.
- Provide a grease-trap to the drainage outlet from kitchens.
- Regularly clean grease-traps and drainage systems.
- Ensure the head of the drainage system is vented at a high level using a vent stack.

Litter from Licensed Premises:

- Encourage customers to dispose of litter responsibly using posters inside premises and on bins.
- Arrange for the area around the premises to be cleared of litter and fouling on a regular basis, and always at the close of business.

Outdoor lighting late at night:

- Use properly designed screens, baffles, hoods and louvers on lights to control beam.
- Measures not "over-lighting" area-use lighting with an appropriate output for the particular care when selecting tungsten or halogen lighting.
- Ensure the lighting is aimed at the beam away from sensitive premises.
- Turn off lighting when no longer required.
- Ensure lights activated by sensors are properly set and used appropriately repeatedly switching on and off, as this it may cause annoyance.

This page is intentionally left blank